

Uniclass	G251:JB1:L6815		
CI/SfB	(21.9)	Jn7	(M2)

Structherm | Non-Structural Cladding

SYSTEM OVERVIEW & BENEFITS



The Structherm Non-Structural External Wall Insulation Cladding System is an efficient and cost-effective, rendered cladding method for new-build or refurbishment projects.

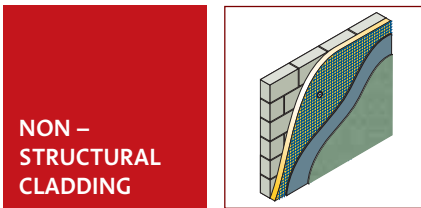

System Overview

Introduction

Structherm's quick and easy-to-use system is based on a sequence of layers built up to form a thermally insulated, weatherproof and attractive envelope suitable for a very wide variety of building types. The layers consist of a CFC and HFC-free insulant overlaid in turn with reinforcing mesh, basecoat render and a surface finish.

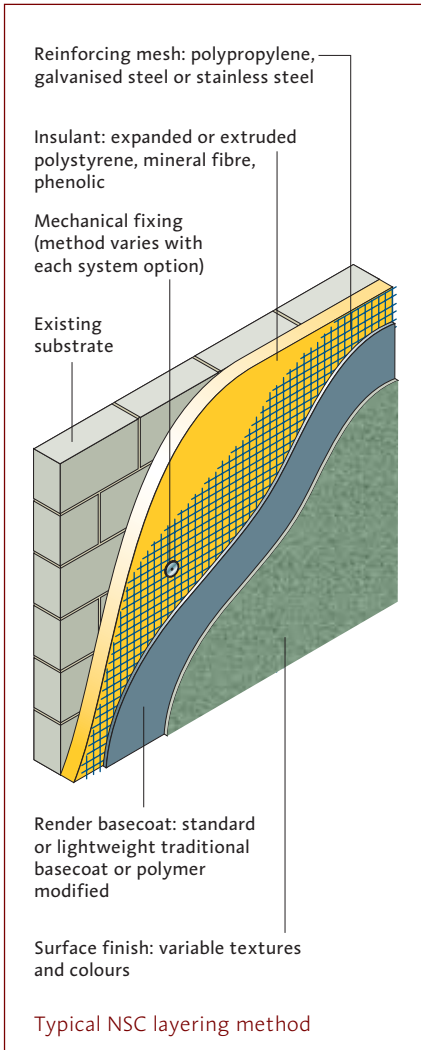

System options

The system has 6 options, NSC 1, 2, 3, 4, 5 and 6, all based on the same sequence of layers of insulant, mesh, basecoat render and surface finish. The distinguishing aspect of each option is the particular combination of these layers, and the retention method to be used.

Each option may also be further varied with a choice of 4 insulants that include expanded polystyrene, extruded polystyrene, mineral fibre or phenolic. All insulants are available as rigid boards in standard sizes of 1220 x 610mm and in a standard range of thicknesses from 30mm to 150mm. Other thicknesses are available to suit varying thermal insulation requirements.

Refer to Datasheets 3 to 8 for each option.

See the Renders and Finishes Datasheets for information on the very wide range of textures and colours available.

AREAS OF APPLICATION

DEPENDING ON THE OPTION CHOSEN, THE NSC SYSTEM IS SUITABLE FOR:

1. New build projects.
2. Refurbishment of local authority dwellings.
3. Refurbishment of private dwellings.
4. Public buildings including ground floor areas.
5. For buildings where a traditional appearance is required.
6. Offices.
7. Schools.
8. Commercial premises.
9. Any high-rise or low-rise building.

System Benefits

The unique characteristics of the Structherm Non-Structural External Wall Cladding System offer many benefits for those engaged in either new build or the refurbishment process.

1. Thermal performance

Significantly improves the thermal efficiency of walls, thereby reducing fuel consumption and environmental pollution.

2. BBA certification

BBA Certificate No. 96/3243 indicates that the system may be used without restriction of height or exposure, and has an assessed life of at least 30 years.

3. Impact resistance

Impact resistance of 6 N/m has been attained.

4. Easy handling, rapid installation

The low weight of the rigid insulation boards makes them easily handled by one person, and readily cut or shaped on site to suit complicated configurations.

5. Fire

The system is classified Class 0 as defined in the Building Regulations.

6. Acoustic performance

Transmission of external airborne noise through the external wall is much reduced using the system.

7. Insulants

Four standard insulants are available giving a range of thermal performance figures to suit any application.

8. Renders and surface finishes

The external render face offers a high level of weather protection and is virtually maintenance free.

9. Moisture

In addition to their water resistant properties, renders are also vapour permeable to allow natural drying of existing walls.

10. Condensation

No risk of condensation because dew point occurs on the outside of the system.

11. Ancillary materials

A range of standard profiles and fixings for finishing corners and edges complements the system components, offering complete continuity of the system across the building facade.

12. Minimising disruption

In refurbishment projects, occupants do not have to vacate the building because all work access and installation are external.

