

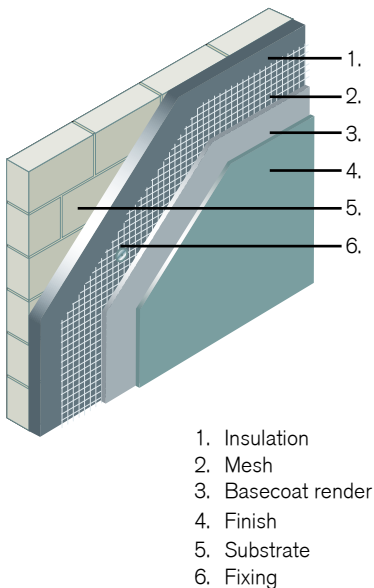

NSC 1 is a lightweight insulated render system that is an efficient, seamless, cost-effective rendered cladding method for newbuild or refurbishment projects.



Diagram 1 Insulated render sequence of layers (NSC 1)



Insulants

All insulants are CFC-free, available as rigid boards in standard sizes of 1220 x 610mm and in a standard range of thicknesses from 30mm to 200mm. Other thicknesses are available to suit varying thermal insulation requirements. The boards have either plain or tongued and grooved edges on all sides.

The range of insulants includes:
 Expanded polystyrene 30 kg/m³
 Platinum expanded polystyrene 30kg/m³
 Mineral fibre 140 kg/m³

Mechanical Fixings

Selected proprietary insulation fixings are applied prior to the application of the render at the rate of 4-6 per m², depending upon individual specifications. Available in polypropylene or stainless steel.

Mesh

Glass Fibre Mesh in sheet or roll form, embedded in a 1 mm skim of bonding render. Adjoining areas of mesh should have 100mm cover laps.

Application

The Bonding Bianco/Grigio is a high polymer material which is used to fix the insulant to the substrate. The product is applied to the face of the insulant and the reinforcing mesh is trowelled into the render insulant whilst wet. A further coat of Cortina TH is applied 1.5mm thick, after which a sponge float may be

used to flatten the surface prior to the surface finish being applied.

Surface finishes

Flesscoat Cortina TH 1-1.5mm thick gives a variety of coloured and textured finishes. The durable, maintenance free coating is composed of selected marble chips and powder and acrylic co-polymers, set in an emulsion base with siliceous aggregates, additives, bactericides and inorganic pigments. Siloxane and silicate based finishes are also available for enhanced performance.

Accessories

A wide range of bellcast, capping, bead and joint profiles are available in PVC-U with Glass Fibre Mesh wings to suit all requirements.

Characteristics of OptionThermaphon NSC 1:

- a) Fast installation
- b) High thermal efficiency
- c) Good impact strength
- d) Vapour permeable
- e) Flexible choice of final texture and colour
- f) No expansion joints required

Typical applications

Suitable for new-build projects, the refurbishment of local authority or private dwellings and for public buildings including ground floor areas (using additional reinforcement).

