

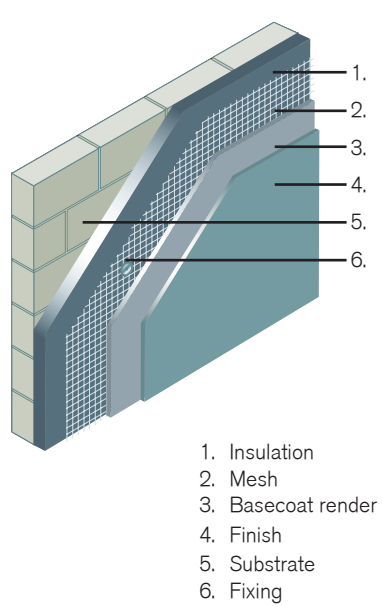

NSC 2 is a lightweight insulated render system that is an efficient, cost-effective rendered cladding method for newbuild or refurbishment projects.



Diagram 1 Insulated render sequence of layers (NSC 2)



Insulants

All insulants are CFC-free, available as rigid boards in standard sizes of 1200 x 600mm and in a standard range of thicknesses from 20mm to 120mm. Other thicknesses are available to suit varying thermal insulation requirements. The boards have either plain or tongued and grooved edges on all sides.

The range of insulants includes:
 Expanded polystyrene 16 kg/m³
 Extruded polystyrene 30 kg/m³
 Mineral fibre 140 kg/m³
 Platinum EPS 15 kg/m³
 PIR 32 kg/m³

Fixings

Selected, proprietary, insulation fixings nominally at the rate of 6-8 per m², depending upon individual specifications. Available in polypropylene or stainless steel.

Mesh

Polypropylene reinforcing mesh in sheet or roll form, embedded in a 3mm skim of basecoat render. Adjoining areas of mesh should have 100mm cover laps.

Basecoat Render

Structherm quality controlled, Polymer Modified basecoat render or lightweight basecoat render, both incorporating lightweight aggregates and reinforcing polyester fibres. In addition to the initial 3mm skim coat, the basecoat render is also applied over the mesh to a final thickness of 6mm.

Surface Finishes

May be either of the following:

a) Flesscoat Cortina TH 1–1.5mm thick gives a variety of coloured and textured finishes. The durable, maintenance free coating is composed of selected marble chips and powder and acrylic co-polymers, set in an emulsion base with siliceous aggregates, additives, bactericides and inorganic pigments. Siloxane and silicate based finishes are also available for enhanced performance.

b) Polymer Modified Dash Receiver (pre-bagged) finish applied in one coat to a nominal thickness of 8mm. Whilst the Dash Receiver is still green, a selected dashing aggregate coat is thrown over the surface using a hand scoop.

c) Macerend Brick Effect Render finish.

d) Macerend Stone Effect Render finish.

Accessories

A wide range of bellcast, capping, bead and joint profiles are available in aluminium, galvanised steel, stainless steel and PVC-U to suit requirements.

Characteristics of Option NSC 2:

- a) Fast installation.
- b) High thermal efficiency.
- c) High level of impact strength.
- d) Vapour permeable.
- e) Flexible choice of final texture and colour.

Typical Applications

Suitable for new-build projects, the refurbishment of local authority or private dwellings, and for public buildings including ground floor areas.



Dumbie Dykes, Edinburgh



The Crescent, Cheltenham



University Accommodation, Sheffield