

Uniclass	G251:JB1:L6815		
CI/SfB	(21.9)	Jn7	(M2)

Structherm | Non-Structural Cladding

EXTERNAL WALL INSULATION SYSTEM OPTION NSC 4



This is one of six options that forms part of the Structherm Non-Structural External Wall Insulation Cladding System. The system is an efficient and cost-effective, rendered cladding method for new-build or refurbishment projects.

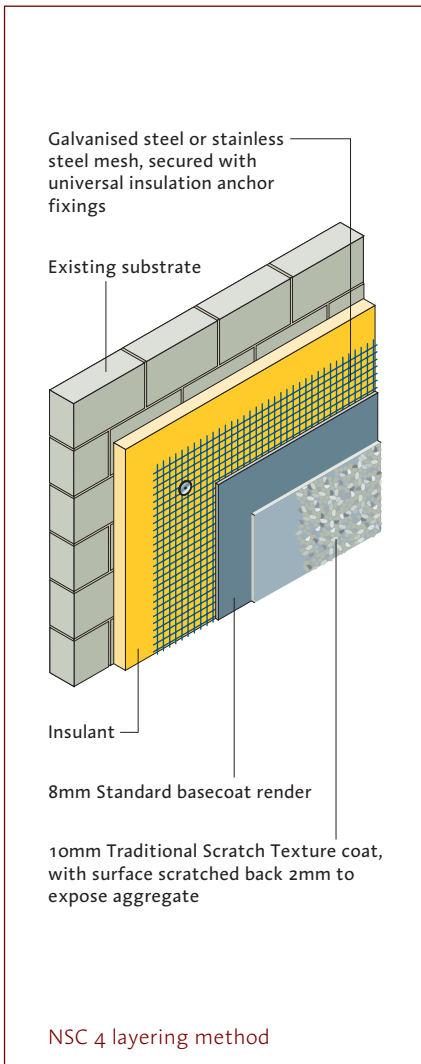
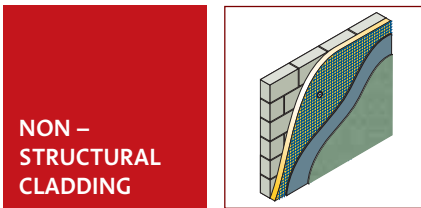

Insulants

All insulants are CFC-free, available as rigid boards in standard sizes of 1220 x 610mm and in a standard range of thicknesses from 30mm to 150mm. Other thicknesses are available to suit varying thermal insulation requirements. The boards have either plain or tongued and grooved edges on all sides.

The range of insulants includes:

Expanded polystyrene	15 kg/m ³
Extruded polystyrene	30 kg/m ³
Mineral fibre	140 kg/m ³
Phenolic	30 kg/m ³

Fixings

Selected, proprietary, insulation fixings nominally at the rate of 6-8 per m², depending upon individual specifications. Available in polypropylene or stainless steel.

Mesh

Galvanised steel or stainless steel reinforcing diamond mesh in sheet form, secured with universal insulation anchor fixings. Adjoining areas of mesh should have 100mm cover laps.

Basecoat render

Structherm quality controlled, Standard basecoat render (pre-bagged) applied in one coat, to a nominal thickness of 8mm.

Surface finishes

Traditional Scratch Texture (pre-bagged) finish applied in one coat to a nominal thickness of 10mm, and scratched back to a final total thickness of 8mm to expose the aggregate.

Accessories

A wide range of bellcast, capping, bead and joint profiles is available in aluminium, galvanised steel and stainless steel to suit individual requirements.

Characteristics of Option NSC 4

- a) Fast installation.
- b) High thermal efficiency.
- c) An extremely high degree of impact resistance.
- d) Vapour permeable.
- e) Flexible choice of final texture and colour.

Typical applications

Suitable for new-build projects, the refurbishment of local authority or private dwellings, and for public buildings including ground floor areas. Also suitable where a traditional appearance is required.

