

Uniclass	G251:JB1:L6815		
CI/SfB	(21.9)	Jn7	(M2)

Structherm | Non-Structural Cladding

EXTERNAL WALL INSULATION SYSTEM OPTION NSC 5



This is one of six options that forms part of the Structherm Non-Structural External Wall Insulation Cladding System. The system is an efficient and cost-effective, rendered cladding method for new-build or refurbishment projects.

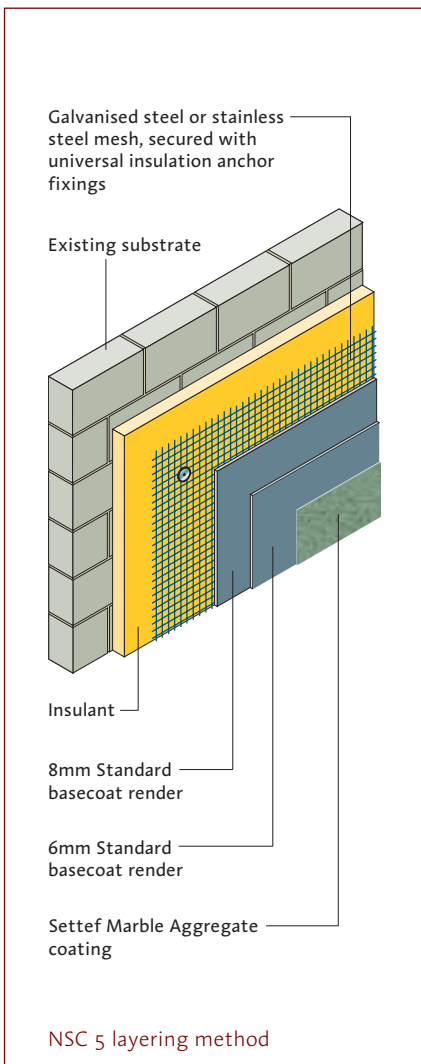
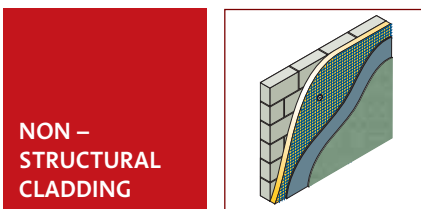

Insulants

All insulants are CFC-free, available as rigid boards in standard sizes of 1220 x 610mm and in a standard range of thicknesses from 30mm to 150mm. Other thicknesses are available to suit varying thermal insulation requirements. The boards have either plain or tongued and grooved edges on all sides.

The range of insulants includes:

Expanded polystyrene	15 kg/m ³
Extruded polystyrene	30 kg/m ³
Mineral fibre	140 kg/m ³
Phenolic	30 kg/m ³

Fixings

Selected, proprietary, insulation fixings nominally at the rate of 6-8 per m², depending upon individual specifications. Available in polypropylene or stainless steel.

Mesh

Galvanised steel or stainless steel reinforcing diamond mesh in sheet form, secured with universal insulation anchor fixings. Adjoining areas of mesh should have 100mm cover laps.

Basecoat render

Structherm quality controlled, Standard basecoat render (pre-bagged) with the first coat applied to a nominal thickness of 8mm. The second coat is applied to a thickness of 6mm, finished flat.

Surface finishes

Settef Marble Aggregate wall coating 1.5-3.0mm thick giving a variety of coloured and textured finishes. The durable, maintenance-free coating is composed of selected marble chips and powder, and acrylic co-polymers set in an emulsion base with siliceous aggregates, additives, bactericides and inorganic pigments.

Accessories

A wide range of bellcast, capping, bead and joint profiles is available in aluminium, galvanised steel and stainless steel to suit individual requirements.

Characteristics of Option NSC 5

- a) Fast installation.
- b) High thermal efficiency.
- c) An extremely high degree of impact resistance.
- d) Vapour permeable.
- e) Flexible choice of final texture and colour.

Typical applications

Suitable for all applications, including high rise, public buildings, offices and schools, together with low rise and domestic developments.

