

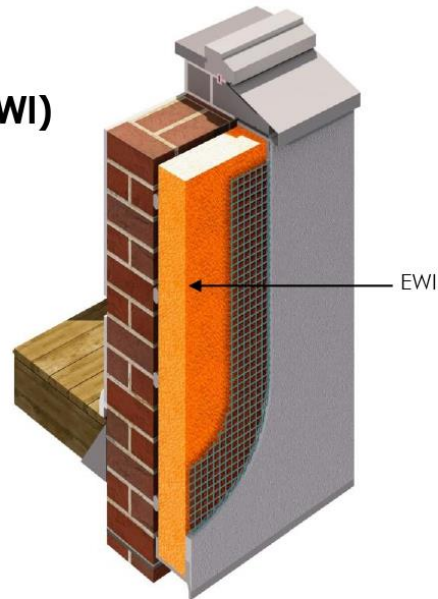

## Jablite External Wall Insulation (EWI)

### Key Benefits

- Available in a range of Lambda values
- 100% recyclable
- Off-cut collection
- Achieves an A+ rating in the BRE Green Guide to Specification
- Lightweight and easy to handle
- Flood proof and durable
- Can be cut to fit with a sharp knife
- Helps to achieve a high quality rendered surface
- Insulates for the lifetime of the building
- Reaction to Fire Class E



Jablite EWI is manufactured from expanded polystyrene (EPS) and can be bonded and/or mechanically fixed to an external wall. It can be used in conjunction with a variety of render and cladding systems including timber or plastic weatherboarding, tile hanging and reinforced-render systems.

### Jablite EWI Properties

#### Dimensions

Standard size: 1200mm x 600mm  
Standard thickness: From 20mm – 200mm

#### Type

Jablite EWI is supplied as EPS 70E (white), EPS HP70 E (grey) and EPS HP+70 E (grey) as defined in BS EN 13163. All our EWI contain a flame retardant additive to achieve Reaction to Fire Class E. Jablite EWI for use with a rendered finish should be "aged" material.

#### Easy to install

Jablite EWI is manufactured from expanded polystyrene (EPS) which is lightweight and easy to handle. It is easily installed and there is generally no need for specialised trades or equipment, therefore disruption to the building occupants is minimal.

#### Environment

EPS has been awarded an A+ rating by the BRE's Green Guide to specification.

#### Permanent

Jablite EWI is rot-proof and durable and will remain effective for the life of the building; recommended fixing methods will retain the boards permanently in position. It also has the added advantage of being flood-proof.

#### Fire

Any necessary fire performance should be provided by the facing material and the system design.

#### Water vapour transmission

Jablite EWI offers significant resistance to the passage of water vapour, but should not be regarded as a vapour-control layer.

Condensation calculations covering typical environmental conditions show that the dew point of an external-wall insulation system will occur on the external face of the insulation. This is the ideal situation.





## Jablite External Wall Insulation

### Thermal Resistance (R-Values)

Board thickness	EPS 70E white (thermal conductivity of 0.038 W/mK)	EPS HP70E grey (thermal conductivity of 0.032 W/mK)	EPS HP+70E grey (thermal conductivity of 0.030 W/mK)
40mm	1.05m <sup>2</sup> K/W	1.25m <sup>2</sup> K/W	1.30m <sup>2</sup> K/W
50mm	1.30m <sup>2</sup> K/W	1.55m <sup>2</sup> K/W	1.65m <sup>2</sup> K/W
60mm	1.55m <sup>2</sup> K/W	1.85m <sup>2</sup> K/W	2.00m <sup>2</sup> K/W
75mm	1.95m <sup>2</sup> K/W	2.30m <sup>2</sup> K/W	2.50m <sup>2</sup> K/W
80mm	2.10m <sup>2</sup> K/W	2.50m <sup>2</sup> K/W	2.65m <sup>2</sup> K/W
90mm	2.35m <sup>2</sup> K/W	2.80m <sup>2</sup> K/W	3.00m <sup>2</sup> K/W
100mm	2.60m <sup>2</sup> K/W	3.10m <sup>2</sup> K/W	3.30m <sup>2</sup> K/W
110mm	2.85m <sup>2</sup> K/W	3.40m <sup>2</sup> K/W	3.65m <sup>2</sup> K/W
120mm	3.15m <sup>2</sup> K/W	3.75m <sup>2</sup> K/W	4.00m <sup>2</sup> K/W
130mm	3.40m <sup>2</sup> K/W	4.05m <sup>2</sup> K/W	4.30m <sup>2</sup> K/W
150mm	3.95m <sup>2</sup> K/W	4.65m <sup>2</sup> K/W	5.00m <sup>2</sup> K/W

### Accessory Products - Jablite Basetherm

Jablite Basetherm is a high performance insulation board that is designed specifically to insulate the plinth below the damp-proof course and provide an impact proof base board. It is made of expanded polystyrene which maintains the thermal performance of the insulation even in a damp environment and can be used in conjunction with Jablite external wall insulation.

#### Dimensions

Standards size : 1200mm x 1200mm  
 Standard Thicknesses: 50mm or 100mm

#### Key properties:

200 Grade – High density EPS  
 Normal density: 30 kg/m<sup>3</sup>  
 Compressive strength – 200kPa  
 Tensile Strength – minimum 100kPa  
 Flatness – 3mm

#### Test to prove performance:

Compression testing to 10% - BS EN 13163  
 Tensile – EN1607

